

**For each application the appropriate holding magnet**

- ⇒ Large stock
- ⇒ Samples for R&D
- ⇒ Custom-made magnets
- ⇒ Production of prototypes
- ⇒ Consulting service

**Technical and economical optimal solutions  
 are our target!**

**Rubber coated magnet with soft, anti-slip holding surface**

Selection of our stock items (other specifications upon request)

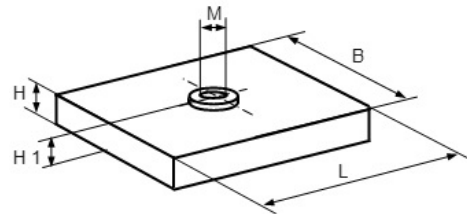

Item no.	Dimensions in mm						Force
	L	B	H	H1	M	kg	
80.0008.A	43	31	6	7	M6	10	
80.0008.B	43	31	6	7	M4	10	

**Possible applications**

e.g. as a magnetic base for attaching advertising media, taxi signs, roof carriers etc. on vehicles

e.g. as a wall magnet at office walls for hanging pictures, dresses etc.

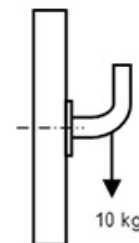
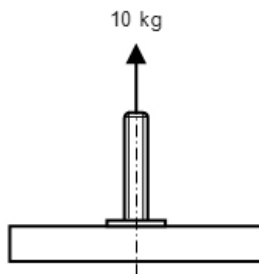

**Characteristic**

- Magnet material NdFeB (Neodymium)
- Coating Santoprene
- No scratching of painted / anodized surfaces
- Especially suitable for thin, uneven steel sheets as on car roofs
- Loadable on tensile- or shear force
- Slip resistance up to the holding force

**Rubber coated magnet with soft, anti-slip and adaptable holding surface**

Selection of our stock items (other specifications upon request)

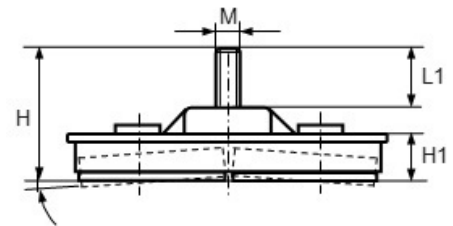
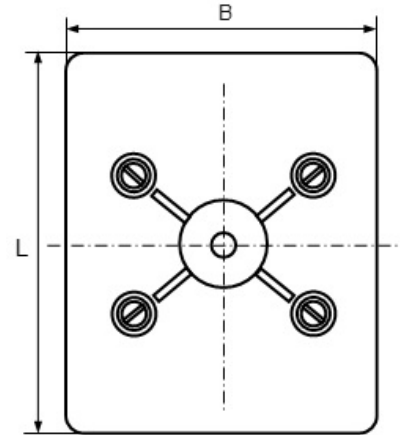

Item no.	Dimensions in mm						Force
	L	B	H	H1	M	L1	kg
80.0009	97	73	37	12	M6	18	40

**Characteristic**

- Magnet material NdFeB (Neodymium)
- Coating Santoprene
- Housing plastic, black
- Multi-part, adaptable holding surface
- No scratching of painted / anodized surfaces
- Especially suitable for thin, uneven steel sheets as on car roofs for attaching advertising media, taxi signs, roof carriers etc.
- Loadable on tensile- or shear force
- Slip resistance up to the holding force

**Rubber coated magnet with soft, anti-slip holding surface**

Selection of our stock items (other specifications upon request)

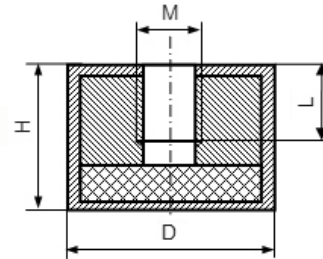

Item no.	Dimensions in mm				Force kg
	D	H	M	L	
63.4201	20±0.2	13.5±0.2	M4	5	10

**Possible applications**

e.g. as a magnetic base, as ceiling magnet etc.

e.g. as a wall magnet at office walls for hanging pictures, dresses etc.

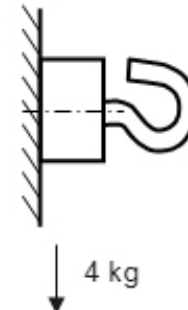
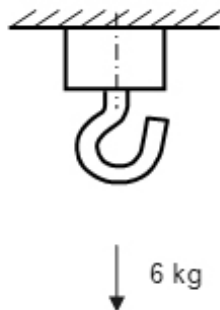

**Characteristic**

- Magnet material NdFeB (Neodymium)
- Coating rubber white (other colours upon request)
- No scratching of painted / anodized surfaces
- Loadable on tensile- or shear force
- Working temperature up to 80°C